

Mapping for Digital 128-Channel Probe

SPI connector

ASSY-325D P-1 / P-2

Electrodes are located on both sides of the probe - use Shank A orientation as a reference to construct the channel-map with respect to your brain target.
Electrode numbers are 0-indexed so as to correspond to the Intan / Open Ephys data-acquisition software channels.

Red Wire and White Wire correspond to indicated REF and GND inputs to the headstage amplifier.

Shank D (back)		C (back)		B (back)		A (back)	
	90		74		58		42
95	89	79	73	63	57	47	41
94	88	78	72	62	56	46	40
93	87	77	71	61	55	45	39
92	86	76	70	60	54	44	38
91	85	75	69	59	53	43	37
84	83	68	67	52	51	36	35
82	81	66	65	50	49	34	33
80		64		48		32	

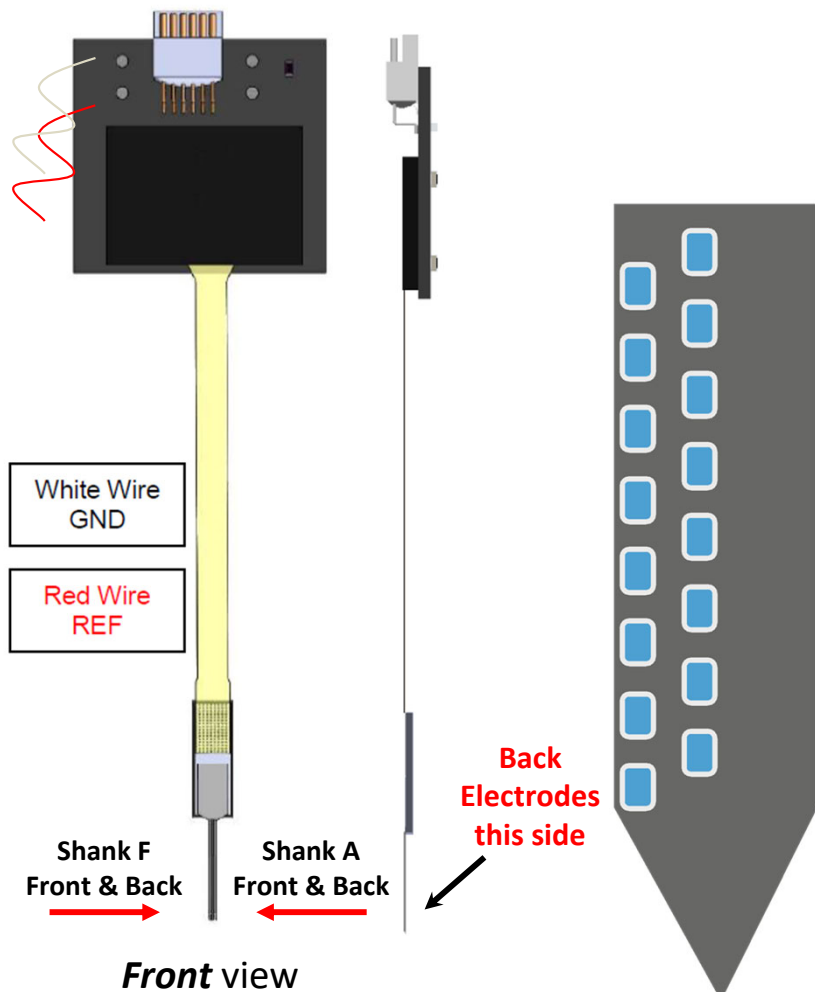

D (front)		C (front)		B (front)		Shank A (front)	
	106		122		10		26
111	105	127	121	15	9	31	25
110	104	126	120	14	8	30	24
109	103	125	119	13	7	29	23
108	102	124	118	12	6	28	22
107	101	123	117	11	5	27	21
100	99	116	115	4	3	20	19
98	97	114	113	2	1	18	17
96		112		0		16	